

## HRC Fuse Holders

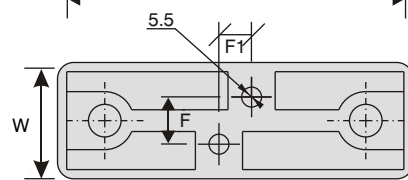

TYPE	L	L1	H	W	F	F1
SFH20A	66	80.5	43	25	-	-
SFH32A	98	103	62	32	13	9
SFH63A	104	109	68	35	12	6

Tested at ERDA (Baroda) & ERTL (Mumbai)

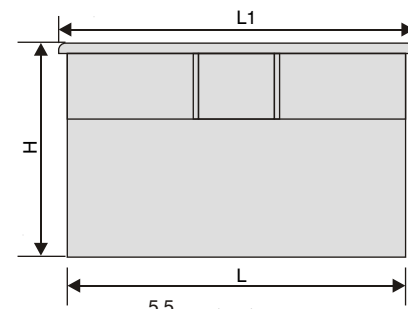
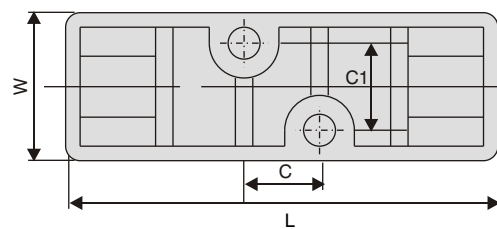
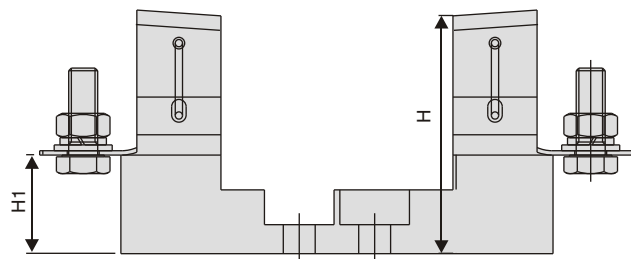

TYPE	L	H	H1	W	C	C1
SFL125A	130	64	20	35	25	-
SFL250A	149	82	34	51	26	30

Tested at ERDA (Baroda) & ERTL (Mumbai)

Note: Due to continuous improvements the products manufactured may deviate slightly from those specified in this publication. For latest information please contact our office listed here.

## Relay-Timer - Sockets

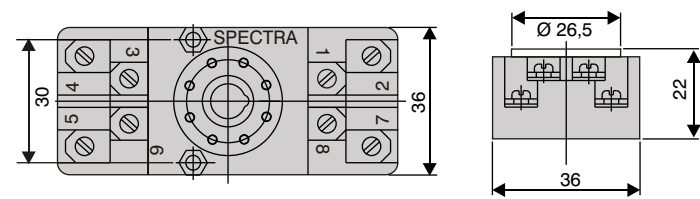

8 Pin

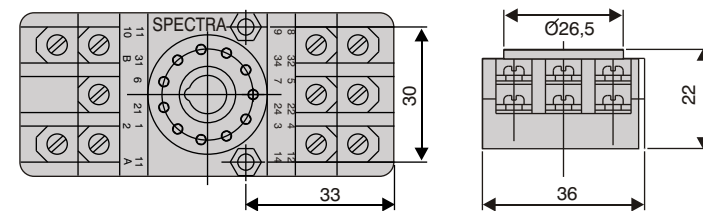

11 Pin

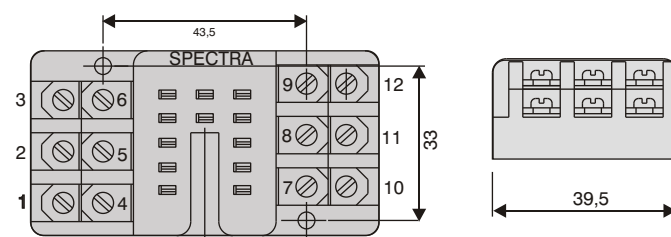

11 Pin -3R4R

### Salient Features

- Compact, sturdy & light weight.
- Specially partitioned terminals for withstanding high voltage.
- Front connections to all terminals & ease of termination of two wires of 1.5sq.mm for looping.
- Tubular contacts for greater contact reliability.
- Body material : Electrical Grade Phenol Formaldehyde
- Contact material : Phosphor Bronze - Tin plated
- Terminals : Brass-Tin plated with Copper base
- Rating : 10A, 250V AC
- Dielectric Strength : 2.5 KV for 1 Min.
- Insulation Resistance : 100M At 500V DC
- Ambient Temp. : +40°C to + 85°C



# SPECTRA ELECTRICALS PVT. LTD.

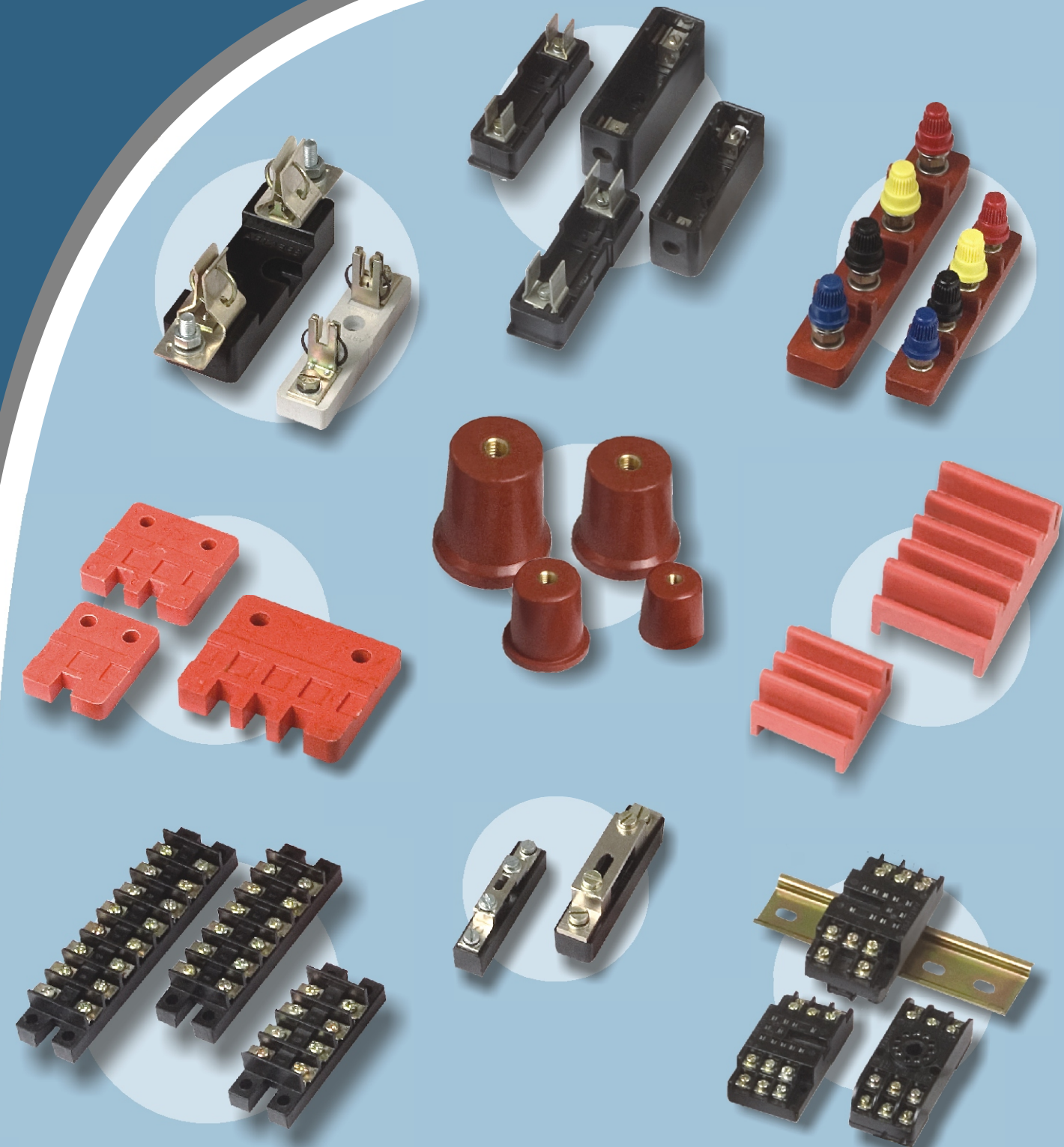

**SPECTRA ELECTRICALS PVT. LTD.**

28/23, D-2 Block, M.I.D.C. Chinchwad, Pune - 411 019. Tel: 020-27476528.

E-mail: [spectraelectricals@rediffmail.com](mailto:spectraelectricals@rediffmail.com)

Authorised Dealer

**Switchgear and Control Panel Accessories**

## About The Company

The Company acquired state of the art manufacturing facilities in the year 1990 and commenced manufacturing of components and mouldings for electrical and home appliances industries. The Company was known for its quality supply of custom built moulding in DMC, SMC & Bakelite for specialized applications. Gradually **SPECTRA ELECTRICALS PRIVATE LIMITED** upgraded its manufacturing activities in the field of low tension switchgear and control panel accessories. In a couple of years **SPECTRA** established its own identity in the electrical market with the expanded range of products to suit the needs of the market. **SPECTRA** has latest production facilities such as temperature and pressure controlled hydraulic presses for manufacturing moulded components. All products are designed using Computer Aided Design tools like AutoCAD. The moulds and components are made on precision machines to maintain the critical dimensions. All products are assembled on modern assembly lines with inbuilt stage inspections.

The busbar supports, fuse bases, relay / timer sockets and test terminal blocks, neutral links are few of the regular products of **SPECTRA ELECTRICALS PRIVATE LIMITED**. Apart these regular products, **SPECTRA** also manufactures custom made moulded components for specialized applications. The **SPECTRA'S** Busbar supports and Fuse bases are tested at ERDA, Baroda and ERTL, Mumbai. Special formulation of DMC and SMC are used in the products as per the requirement of the customer.

To ensure zero defect end products, the materials and finished products are tested with the help of our in-house test facilities for conformance and various quality assurance practices are implemented. These include inspection of incoming raw materials and components, stage inspection at defined check points at manufacturing and assembly stages and final inspection before packing.

**SPECTRA** products are widely accepted by the electrical industry on its quality. Our endeavor is to satisfy customers needs and expectations and enable the Industry to source their entire requirement from **SPECTRA ELECTRICALS PRIVATE LIMITED**.

### Stud Terminals

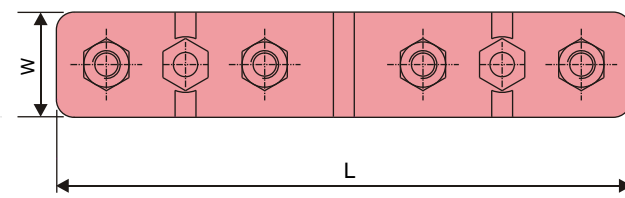
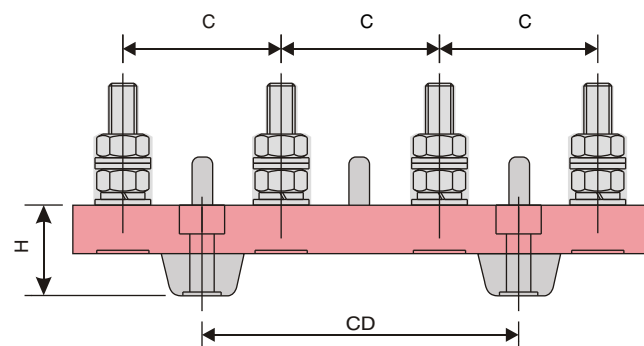

TYPE	L	H	CD	C	W
SP04T	120	20	60	30	26
SP04T1	165	26	90	45.5	30

### Bus Bar Support - Conical Type

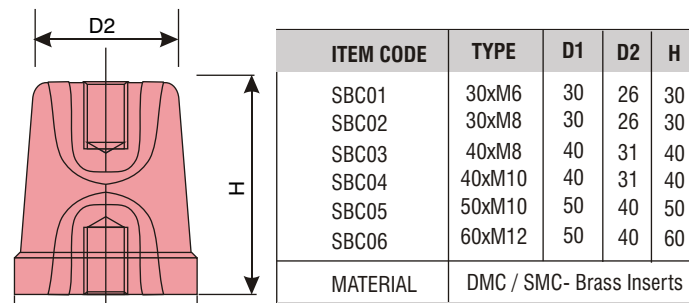

ITEM CODE	TYPE	D1	D2	H
SBC01	30xM6	30	26	30
SBC02	30xM8	30	26	30
SBC03	40xM8	40	31	40
SBC04	40xM10	40	31	40
SBC05	50xM10	50	40	50
SBC06	60xM12	50	40	60

MATERIAL DMC / SMC- Brass Inserts

Tested at ERDA (Baroda)

### Bus Bar Support - Grip Type

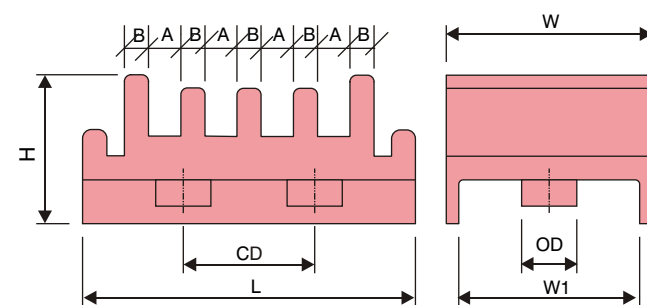

ITEM CODE	WAY	A	B	L	H	CD	W	W1	OD
SBG02	2	7.8	5.6	51	35	30	47	38.5	13
SBG04	4	7.4	5.5	76	34	30	47	38.5	13

MATERIAL DMC / SMC

## Bus Bar Supports - Finger Type

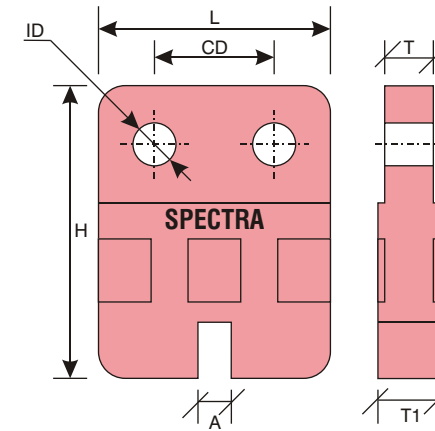

### One way finger type

ITEM CODE	WAY	BUSBAR THK.	A	L	H	CD	ID	T	T1
SBF106	1	6	7.4	51.5	65	26.5	9.5	10.5	13.5
SBF110	1	10	11	51.5	65	26.5	9.5	10.5	13.5
SBF112	1	12	13	51.5	65	26.5	9.5	10.5	13.5

MATERIAL DMC / SMC

Tested at ERDA (Baroda)

### Two way finger type

ITEM CODE	WAY	BUSBAR THK.	A	B	L	H	CD	ID	T	T1
SBF206	2	6	7.4	7.8	70	66	40	8.5	10	14
SBF210	2	10	12	9.6	70	66	40	8.5	10	14
SBF212	2	12	13	12.5	70	66	40	8.5	10	14

MATERIAL DMC / SMC

Tested at ERDA (Baroda)

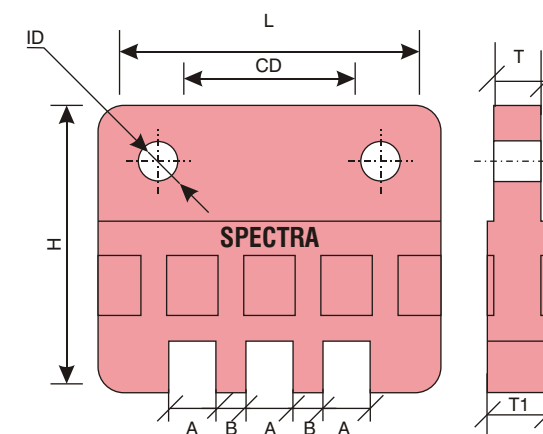
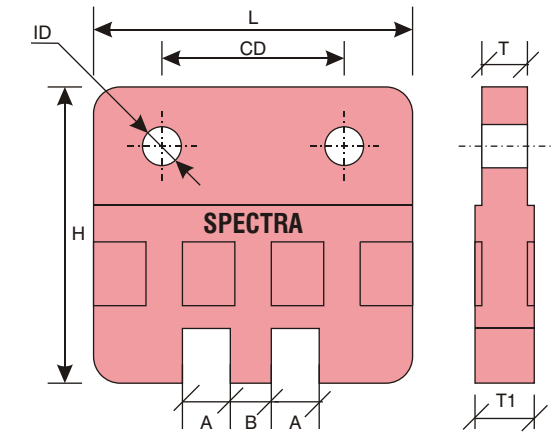

### Three way finger type

ITEM CODE	WAY	BUSBAR THK.	A	B	L	H	CD	ID	T	T1
SBF306	3	6	7.4	7	80	67	50	9	11	14
SBF310	3	10	11	7	80	67	50	9	11	14
SBF312	3	12	13.5	12	100	67	50	9	11	14

MATERIAL DMC / SMC

Tested at ERDA (Baroda)

### Four way finger type

ITEM CODE	WAY	BUSBAR THK.	A	B	H	L	CD	ID	T	T1
SBF406	4	6	7	6	67	80	50	8.6	10	14
SBF410	4	10	11.5	14.6	70	118	75	10	12	16
SBF412	4	12	13.5	12	70	118	75	10	12	16

MATERIAL DMC / SMC

Tested at ERDA (Baroda)

